

AIR TRAFFIC SERVICE SYSTEM(SECTORS,CTAs,TMAs)

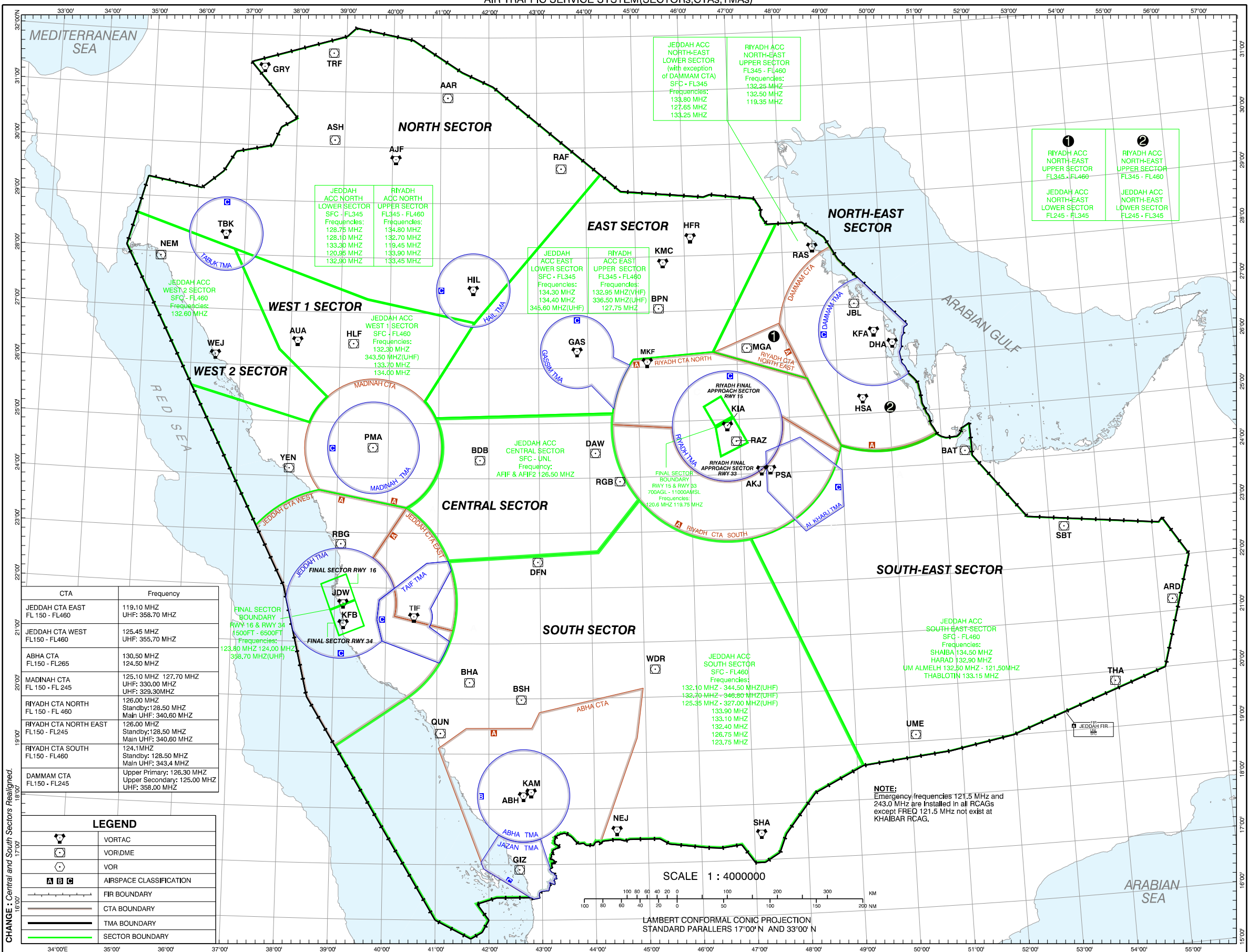

JEDDAH ACC NORTH LOWER SECTOR
SFC - FL345
Frequencies:
123.75 MHZ
123.10 MHZ
133.30 MHZ
120.95 MHZ
132.90 MHZ

RIYADH ACC NORTH UPPER SECTOR
FL345 - FL460
Frequencies:
134.80 MHZ
132.70 MHZ
119.45 MHZ
133.90 MHZ
133.45 MHZ

JEDDAH ACC NORTH-EAST LOWER SECTOR
(with exception of DAMMAM CTA)
SFC - FL345
Frequencies:
133.80 MHZ
127.65 MHZ
133.25 MHZ

RIYADH ACC NORTH-EAST UPPER SECTOR
FL345 - FL460
Frequencies:
132.25 MHZ
132.50 MHZ
119.35 MHZ

1
RIYADH ACC NORTH-EAST UPPER SECTOR
FL345 - FL460
JEDDAH ACC NORTH-EAST LOWER SECTOR
FL245 - FL345

2
RIYADH ACC NORTH-EAST UPPER SECTOR
FL345 - FL460
JEDDAH ACC NORTH-EAST LOWER SECTOR
FL245 - FL345

CTA	Frequency
JEDDAH CTA EAST FL 150 - FL460	119.10 MHZ UHF: 358.70 MHZ
JEDDAH CTA WEST FL150 - FL460	125.45 MHZ UHF: 355.70 MHZ
ABHA CTA FL150 - FL265	130.50 MHZ 124.50 MHZ
MADINAH CTA FL 150 - FL 245	125.10 MHZ 127.70 MHZ UHF: 330.00 MHZ UHF: 329.30MHZ
RIYADH CTA NORTH FL 150 - FL 460	126.00 MHZ Standby:128.50 MHZ Main UHF: 340.60 MHZ
RIYADH CTA NORTH EAST FL150 - FL245	126.00 MHZ Standby:128.50 MHZ Main UHF: 340.60 MHZ
RIYADH CTA SOUTH FL150 - FL460	124.1MHZ Standby: 128.50 MHZ Main UHF: 343.4 MHZ
DAMMAM CTA FL150 - FL245	Upper Primary: 126.30 MHZ Upper Secondary: 125.00 MHZ UHF: 358.00 MHZ

LEGEND	
	VORTAC
	VOR/DME
	VOR
	AIRSPACE CLASSIFICATION
	FIR BOUNDARY
	CTA BOUNDARY
	TMA BOUNDARY
	SECTOR BOUNDARY

NOTE:
Emergency frequencies 121.5 MHz and 243.0 MHz are installed in all RCAGs except FREQ 121.5 MHz not exist at KHAIBAR RCAG.

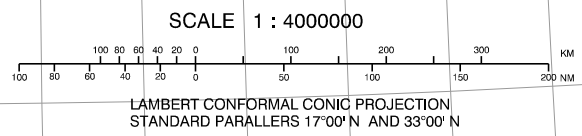

CHANGE : Central and South Sectors Realigned.